

BLACKWELL & ASSOCIATES, INC.
PROFESSIONAL LAND SURVEYORS

20 TEASDALE CIRCLE
NANTUCKET, MASSACHUSETTS 02554
(508) 228-9026
FAX: (508) 228-5292
www.blackwellsurvey.com

B3869

December 12, 2019

Mr. Jeff Carlson, Natural Resources Director
Nantucket Conservation Commission
2 Bathing Beach Road
Nantucket, MA 02554

Re: SE48-1818; #100 Low Beach Road. Property of Alice M. Rochat.

Dear Jeff,

I am writing to request a Certificate of Compliance for the referenced Order of Conditions, as amended.

I certify that the project was completed in substantial compliance with the permit, except for the shed. An amendment application has been submitted to relocate the shed under SE48-3027.

Also, a boardwalk at grade exists along the west side of the smaller structure, beneath the cantilevered balcony, which leads to stone steps at the northwest structure corner. The stone steps were installed in place of the stepping stones shown on the 4/23/08 Jardins International landscape plan attached to the 4/25/08 amendment request.

If you have any questions, please call. Thank you.

Sincerely,

Blackwell & Associates, Inc.
By Jeffrey L. Blackwell, P.L.S.





WPA Form 8A – Request for Certificate of Compliance
Massachusetts Wetlands Protection Act M.G.L. c. 131, §40

A. Project Information

Important:

When filling out forms on the computer, use only the tab key to move your cursor - do not use the return key.



Upon completion of the work authorized in an Order of Conditions, the property owner must request a Certificate of Compliance from the issuing authority stating that the work or portion of the work has been satisfactorily completed.

1. This request is being made by:(current Title holder):

Alice Rochat
Name
100 Low Beach Rd.
Mailing Address
Nantucket MA 02554
City/Town State Zip Code
508-257-4330
Phone Number

2. This request is in reference to work regulated by a final Order of Conditions issued to:

Alice Rochat
Applicant
8/26/2005 Dated SE48-1818
DEP File Number

3. The project site is located at:

100 Low Beach Rd. Nantucket
Street Address City/Town
75 Parcel/Lot Number
Assessors Map/Plat Number

4. The final Order of Conditions was recorded at the Registry of Deeds for : (name on Order)

Alice Rochat
Property Owner (if different)
Nantucket
County Book Page
16226
Certificate (if registered land)

5. This request is for certification that (check one):

the work regulated by the above-referenced Order of Conditions has been satisfactorily completed.

the following portions of the work regulated by the above-referenced Order of Conditions have been satisfactorily completed (use additional paper if necessary).

the above-referenced Order of Conditions has lapsed and is therefore no longer valid, and the work regulated by it was never started.



A. Project Information (cont.)

6. Did the Order of Conditions for this project, or the portion of the project subject to this request, contain an approval of any plans stamped by a registered professional engineer, architect, landscape architect, or land surveyor?

Yes If yes, attach a written statement by such a professional certifying substantial compliance with the plans and describing what deviation, if any, exists from the plans approved in the Order.

No

B. Submittal Requirements

Requests for Certificates of Compliance should be directed to the issuing authority that issued the final Order of Conditions (OOC). If the project received an OOC from the Conservation Commission, submit this request to that Commission. If the project was issued a Superseding Order of Conditions or was the subject of an Adjudicatory Hearing Final Decision, submit this request to the appropriate DEP Regional Office (see <http://www.mass.gov/eea/agencies/massdep/about/contacts/find-the-massdep-regional-office-for-your-city-or-town.html>).

CURRENT ZONING CLASSIFICATION:
 Limited Use General 3 (LUG-3)
 Existing:
 MINIMUM LOT SIZE: 170,000 S.F.
 MINIMUM FRONTAGE: 200 FT.
 FRONT YARD SETBACK: 35 FT.
 REAR YARD SETBACK: 20 FT.
 GROUND COVER %: 3%

Existing:
 571,812 S.F. ±
 SEE PLAN
 SEE PLAN
 SEE PLAN
 SEE PLAN
 SEE PLAN

LEGEND

- or ■ DENOTES MONUMENT POINTS
- DENOTES EXISTING WETLAND FLAG POINTS
- DENOTES EXISTING WETLAND DELINEATION

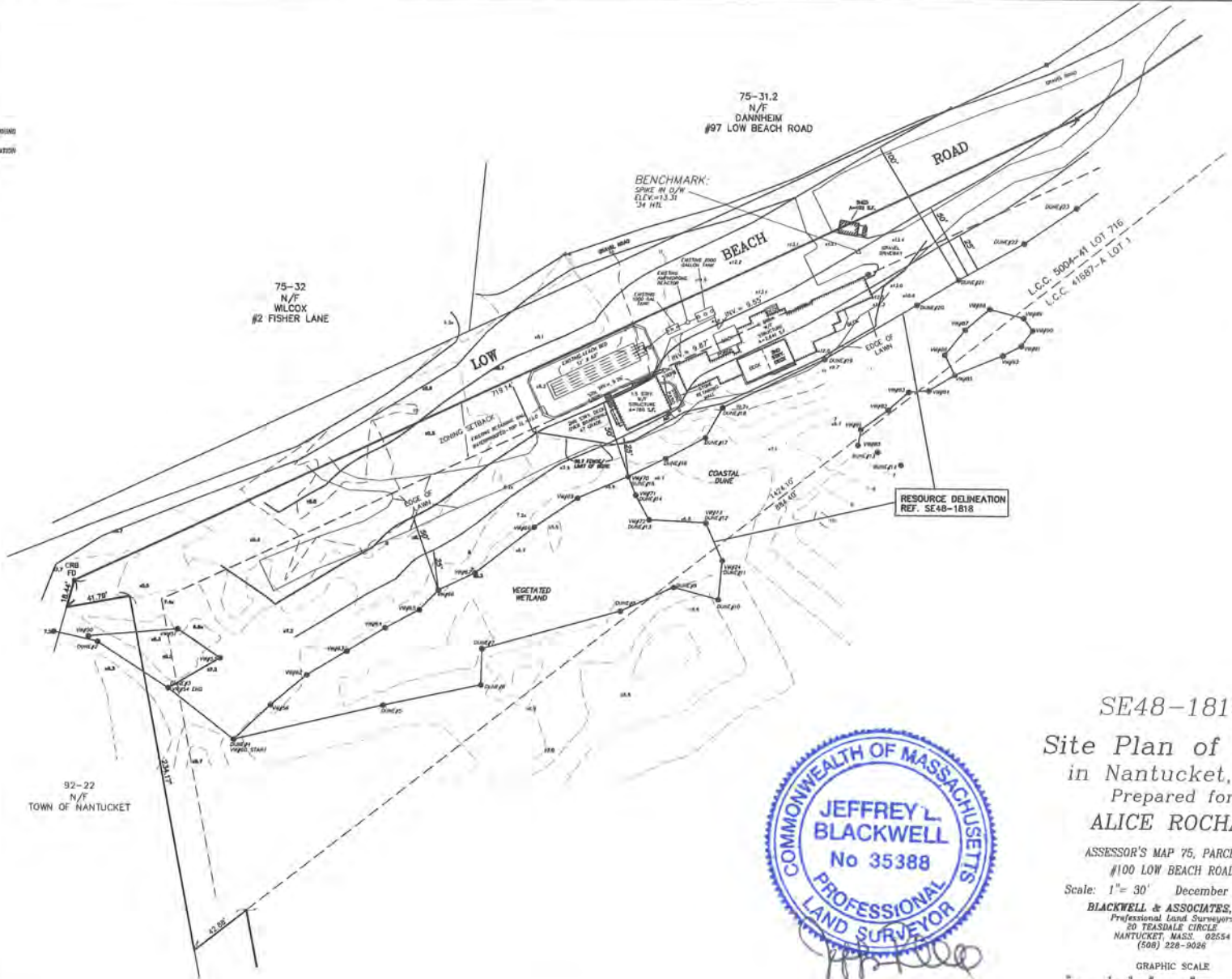

SE48-1818

Site Plan of Land
 in Nantucket, MA
 Prepared for
 ALICE ROCHAT

ASSESSOR'S MAP 75, PARCEL 27
 #100 LOW BEACH ROAD

Scale: 1" = 30' December 12, 2019

BLACKWELL & ASSOCIATES, Inc.
 Professional Land Surveyors
 20 TEASDALE CIRCLE
 NANTUCKET, MASS. 02554
 (508) 228-9026

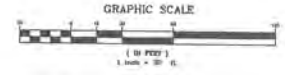

OWNER INFORMATION

ALICE ROCHAT
 L.C.C. 14867-A, LOTS 1 & 2
 L.C.C. 5004-A, LOT 716
 CERT. OF TITLE #18,226
 #100 LOW BEACH ROAD



Massachusetts Department of Environmental Protection
Bureau of Resource Protection - Wetlands

WPA Form 5 —Amended Order of Conditions

Massachusetts Wetlands Protection Act M.G.L. c. 131, §40
And the Town of Nantucket Bylaw Chapter 136

Rochat
DEP File Number:

SE48-1818



2008 00124608

Cert: 16226 Doc: AMENDME
Registered: 07/10/2008 11:52 AM

A. General Information

From: Nantucket
1. Conservation Commission

2. This issuance is for (check one): Order of Conditions Amended Order of Conditions

3. To: Applicant:

Alice Rochat
a. First Name b. Last Name c. Company
101 Mountaintop Road
d. Mailing Address
Bernardsville NJ 07924
e. City/Town f. State g. Zip Code

4. Property Owner (if different from applicant):

Same
a. First Name b. Last Name c. Company

d. Mailing Address

e. City/Town f. State g. Zip Code

5. Project Location:

100 Low Beach Road Nantucket
a. Street Address b. City/Town
75 Land Court Plan no 5004-41 27 (westerly portion) / lot 716
c. Assessors Map/Plat Number d. Parcel/Lot Number

6. Property recorded at the Registry of Deeds for (attach additional information if more than one parcel):

Nantucket 16,226 document 113389
a. County b. Certificate (if registered land)

c. Book d. Page

7. Dates: April 25, 2008 May 7, 2008 May 9, 2008
Date Amended Order Filed Date Amended Public Hearing Closed Date Amended Order Issued
July 15, 2005 August 24, 2005 August 26, 2005
Date Notice of Intent Filed Date Public Hearing Closed Date Orders Issued *

8. Final Approved Plans and Other Documents (attach additional plan or document references as needed):

Site plan to accompany a notice of intent
a. Plan Title
Blackwell & Associated, Inc. Jeffrey L. Blackwell
b. Prepared By c. Signed and Stamped by
August 19, 2005 1"=30'
d. Final Revision Date e. Scale
Septic/studio landscape 048/23/2008
f. Additional Plan or Document Title g. Date

9. Total WPA Fee Paid: \$0.00
a. Total Fee Paid b. State Fee Paid c. City/Town Fee Paid

* Effective date of issuance remains August 26, 2005



CURRENT ZONING CLASSIFICATION:
 Limited Use General 3 (L.U.G.-3) Existing:
 MINIMUM LOT SIZE: 120,000 S.F. 571,832 S.F.±
 MINIMUM FRONTAGE: 200 FT. SEE PLAN
 FRONT YARD SETBACK: 35 FT. SEE PLAN
 REAR/SIDE SETBACK: 20 FT. SEE PLAN
 GROUND COVER % : 3% 0.6% ±

LEGEND

- or ■ DENOTES MONUMENT FOUND
- DENOTES EXISTING WETLAND FLAG FOUND
- DENOTES EXISTING WETLAND DELINEATION

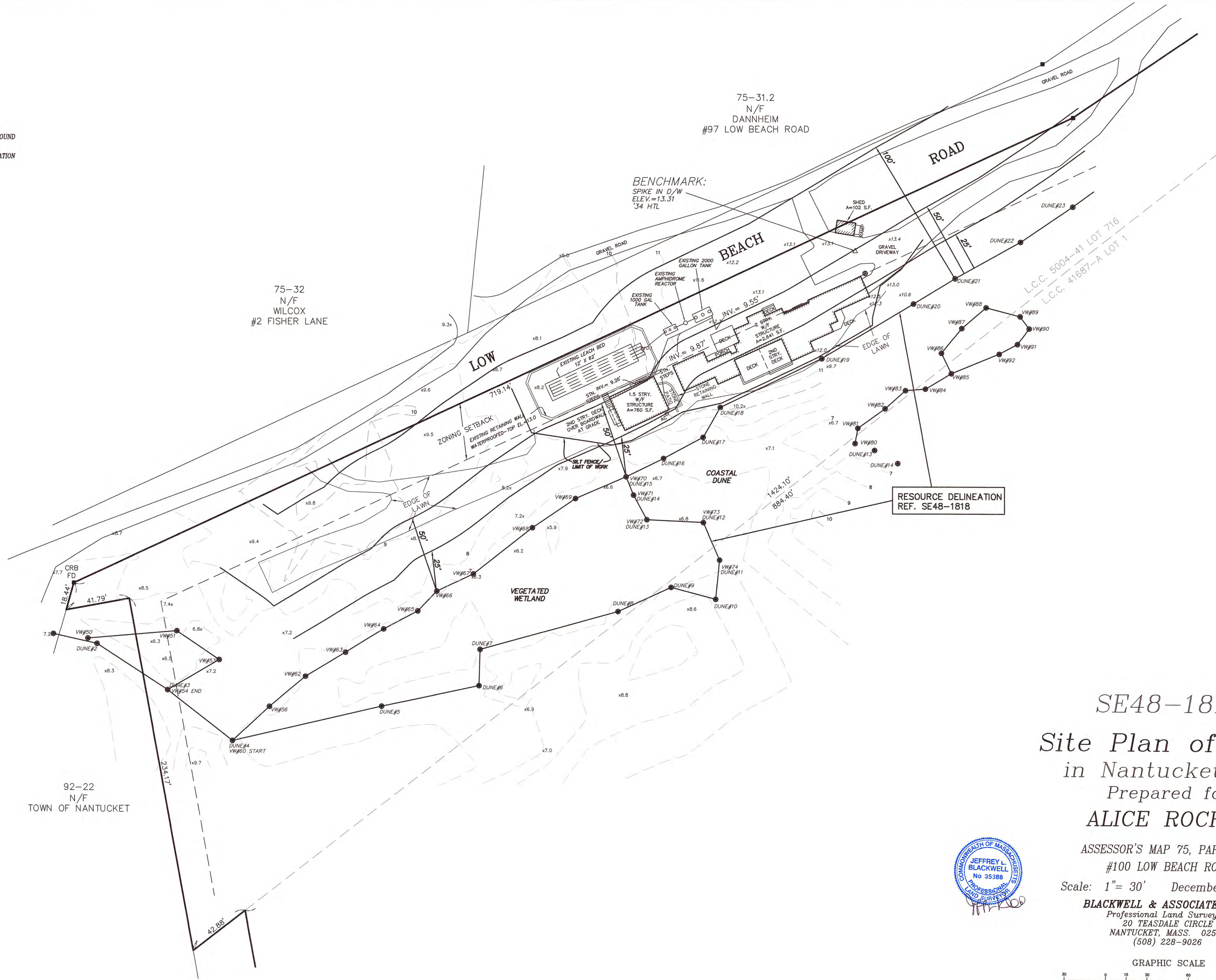

L.C.C. 5004-41 LOT 716
 L.C.C. 41687-A LOT 1

SE48-1818
 Site Plan of Land
 in Nantucket, MA
 Prepared for
 ALICE ROCHAT

ASSESSOR'S MAP 75, PARCEL 27
 #100 LOW BEACH ROAD
 Scale: 1" = 30' December 12, 2019
BLACKWELL & ASSOCIATES, Inc.
 Professional Land Surveyors
 20 TEASDALE CIRCLE
 NANTUCKET, MASS. 02554
 (508) 228-9026

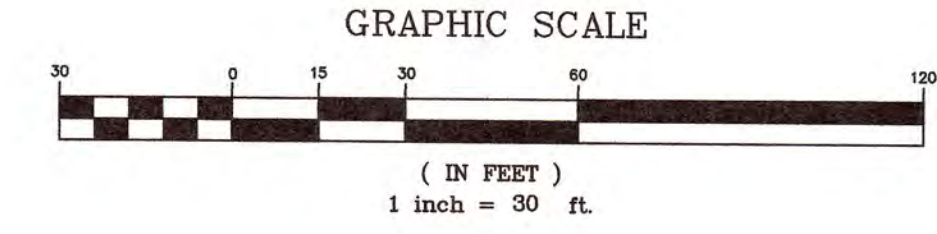

OWNER INFORMATION
 ALICE ROCHAT
 L.C.C. 14687-A, LOTS 1 & 2
 L.C.C. 5004-41, LOT 716
 CERT. OF TITLE #16,226
 #100 LOW BEACH ROAD